

**SCHEDULE AT-A-GLANCE**

[MissouriState.edu/ShowcaseSchedule](https://MissouriState.edu/ShowcaseSchedule)

9 a.m.	Check-In PSU Food Court	Student panel session PSU Theater	Walking campus tours Meet at bronze Bear statue north of PSU. Last tour departs at noon.			
9:30 a.m.		Welcome from Pres. Williams PSU Theater	Student panel session PSU 313	Meet the faculty Foster Rec Center courts		Foster Recreation Center tours Meet at main desk. Last tour departs at 1 p.m.
10 a.m.		Admission and financial aid presentation PSU Theater	Welcome from Pres. Williams PSU 313	Student life expo Foster Rec Center courts	Residence hall tours Meet at the front desks of open residence halls.	
10:30 a.m.			Admission and financial aid presentation PSU 313			
10:30 a.m.	Spanish-language info session PSU 314	Residence Life presentation PSU Theater	Campus shuttle tours Meet at PSU north shuttle stop. Last shuttle departs at noon.			
11 a.m.	Lunch Blair-Shannon Dining Center	Admission and financial aid presentation PSU Theater				
11:30 a.m.			Spanish-language conversations PSU 314			
12 p.m.		Residence Life presentation PSU Theater	Admission and financial aid presentation PSU 313			
12:30 p.m.						
1 p.m.			Transfer admission presentation PSU 314	Ask Admissions PSU main level near info desk		
1 p.m.	BearFest Village (Optional) Tailgate at Bear Head Plaza	Education Abroad presentation PSU 315	Fraternity and Sorority Life presentation PSU 313	Multicultural Resource Center open house		
1:30 p.m.		Education Abroad presentation PSU 315	Fraternity and Sorority Life presentation PSU 313			
2 p.m.	Bears football game (Optional) Plaster Stadium					
2:30 p.m.						
3 p.m.						



**DESCRIPTION OF EVENTS**

**Student panel**

Hear Bears share their experiences about choosing Missouri State.

**Welcome from President Williams**

You'll hear from our awesome president as he welcomes you to campus and explains what makes Missouri State special.

**Residence hall tours**

Go inside our residence halls to explore where you may be living. Tours depart from the front desk of each building.

**Walking tours**

Take a walking tour of campus with a current student. Please allow 30 to 40 minutes for the complete tour. Last tour departs at noon.

**Campus shuttle tours**

These tours provide you with a unique view of campus and offer our story as it can only be told by our students. Please allow approximately 30 minutes for tours. Last shuttle departs at noon.

**Meet the faculty**

This is an opportunity to meet faculty members and advisors who represent more than 170 academic majors and programs. Visit with staff from our Library and Honors College.

**Student Life Expo**

Meet representatives from several campus organizations and student support services.

**Residence Life presentation**

Find out details about the housing application process, benefits of living on campus and more.

**Admission and financial aid presentation**

Learn the basics of the admission process, our costs and scholarship opportunities, important dates and more about becoming a Bear.

**Spanish-language sessions**

All the same helpful info as the English version, but in Spanish! We hope you'll join us for a lively conversation.

**Transfer admission presentation**

Learn the basics of the admission process for college transfer students.

**BearFest Village**

Experience the hype and excitement of a college football atmosphere at Bear Head Plaza.

**Interest area presentations**

Unless otherwise noted, each interest area will host sessions starting at 1 p.m. and 1:30 p.m. Pick your top two to attend:

**• Fraternity and Sorority Life (FSL) presentation**

**PSU, Room 313**  
*Explore our vibrant FSL community. Learn the benefits of joining and how these groups give back to the community.*

**• Multicultural Resource Center open house**

**PSU, first floor (across from Starbucks)**  
*Experience the newly renovated space and services provided. Speak with current students about the Multicultural Resource Center and their experiences on campus. Come and go between 1-2 p.m.*

**• Education Abroad presentation**

**PSU, Room 315**  
*Learn about benefits of studying abroad, financial aid and scholarships, what to expect while overseas and more.*

**EXPLORE OUR FACILITIES**

Open buildings marked with ★ on the map.

These facilities and services will also be open for our Showcase guests to visit:

**9–11 a.m.**

**College of Business at Glass Hall**

Visit Glass Hall to tour COB academic spaces. Meet in the atrium and discover ways to advance your career.

**10 a.m. – 2 p.m.**

**Residence hall tours**

Meet at the front desk of each building to see where you'll be living as a new Bear.

**9:30 a.m. – 1:30 p.m.**

**Foster Recreation Center**

The Foster Recreation Center is a place for the entire campus community to work out, play and learn about healthy living. Enter through main doors from the south side. Last tour departs at 1 p.m.

**11 a.m. – 1 p.m.**

**Lunch in Blair-Shannon Dining Center**

Students eat for **free** at Showcase! Find your coupon in your check-in bag.

**9 a.m. – 3 p.m.**

**Missouri State Bookstore**

Take home some BearWear using your 20% off Showcase discount.

**9 a.m. – noon**

**Brick City art and design facilities**

Rotating shuttles depart from PSU North shuttle stop approximately every 30 minutes. Campus shuttle starts at 8:30 a.m. Last shuttle returning from Brick City departs at 12:15 p.m.

**FOSTER  
RECREATION  
CENTER  
FIRST FLOOR**

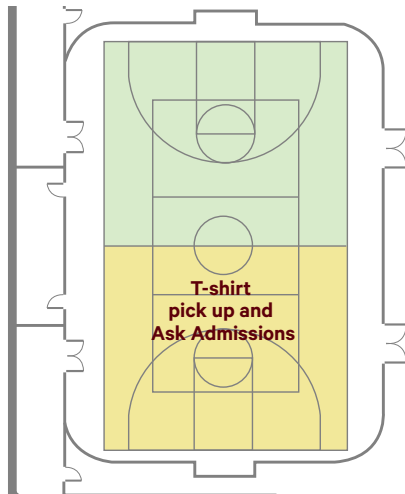

**Meet the faculty/Student life expo**

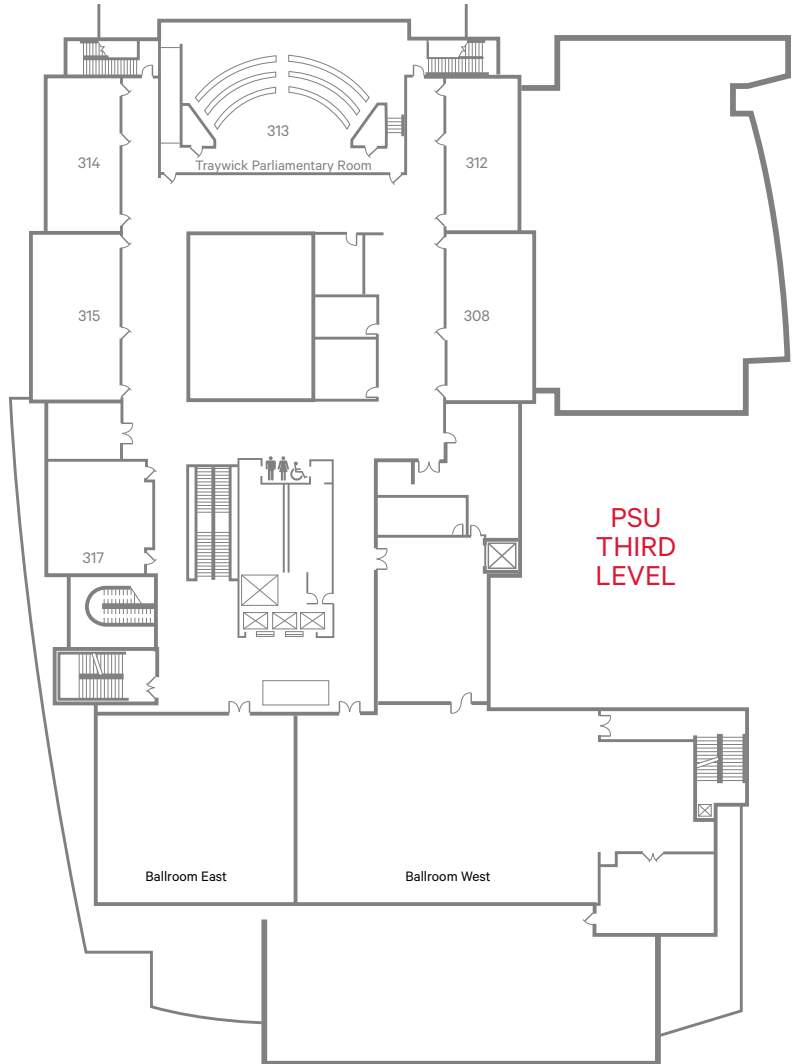
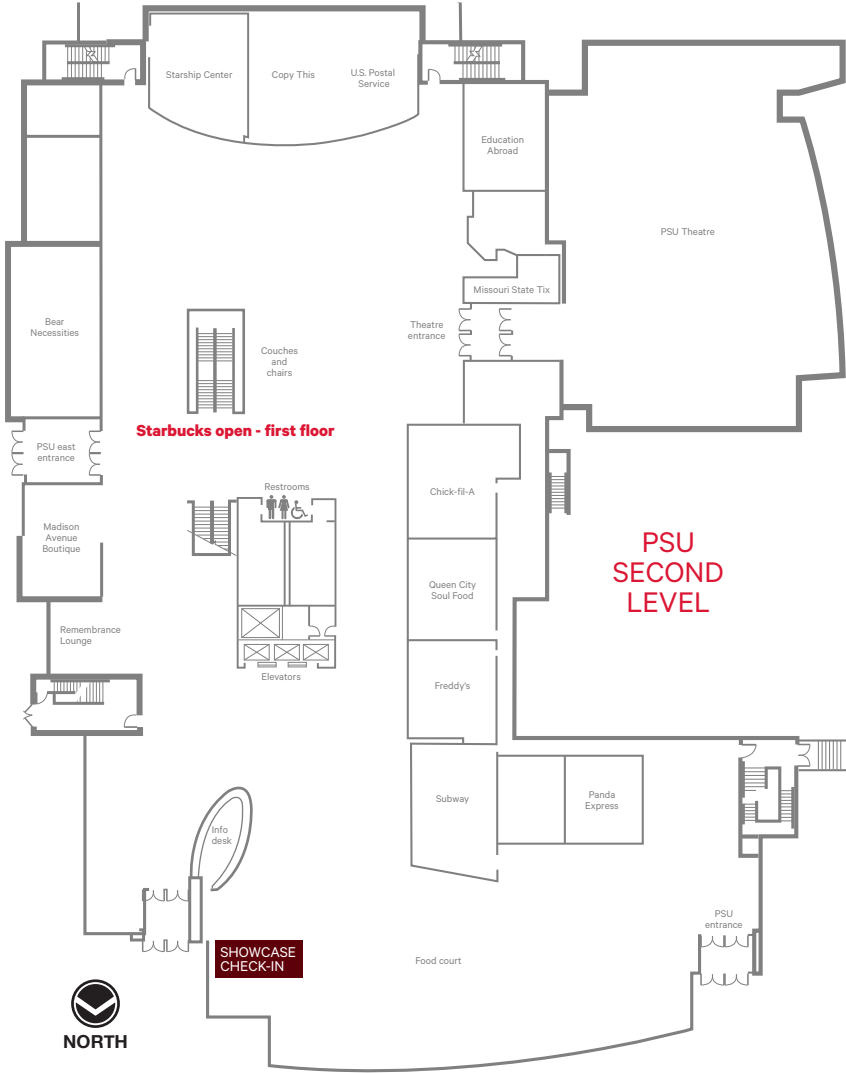
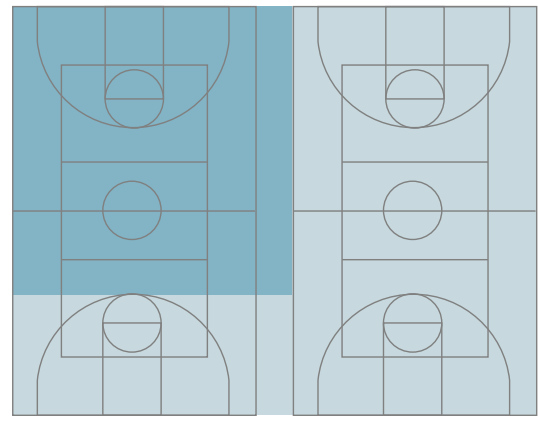

# MAJORS LIST

Missouri State undergraduate students can choose from more than 90 majors that lead to more than 170 academic options. You can even create an individualized major if you know what you want to study but the specific degree is not offered.

## DARR COLLEGE OF AGRICULTURE

### Agricultural Business:

Enterprise Management  
Finance and Management  
Marketing and Sales

### Agricultural Communications

### Agriculture Education

### Animal Science

### Environmental Plant Science:

Crop Science  
Horticulture  
Plant Breeding and Biotechnology

### Equine Science

### General Agriculture\*:

Agricultural Communication  
Agriculture

### Hospitality Leadership\*:

Club Management  
Food and Beverage  
General Operations §  
Lodging  
Senior Living Management  
Tourism

### Natural Resources

### Teaching of Agriculture\*

Wildlife Conservation and Management

## REYNOLDS COLLEGE OF ARTS, SOCIAL SCIENCES AND HUMANITIES

### Anthropology

### Art:

3-D Studies (Ceramics; Metals and Jewelry; Sculpture)  
Computer Animation  
Drawing  
New Media  
Painting  
Photography  
Printmaking

### Art Education

### Communication Studies §

Criminology and Criminal Justice §

### Culture, Literature and Media:

Literature  
Media

### Dance

### Design:

Graphic Design  
Graphic Design and Illustration  
Illustration  
Sequential Art

Digital Film and Television Production

### Electronic Arts:

Audio Studies  
Computer Animation Studies  
Interactive New Media Studies  
Video Studies

### English:

Creative Writing  
Literature

### English Education

### Gerontology

### Global Studies

### History

### History Education

### Journalism

### Literature

### Modern Language\*:

(Spanish only) §  
Applied Business  
Teacher Certification  
Translation  
Two Languages

### Music\*:

Composition  
Instrumental Performance  
Jazz Performance  
Keyboard Performance  
Vocal Performance

### Music Education:

Instrumental  
Vocal/Choral

### Musical Theatre\*\*

### Philosophy

### Political Science

### Professional Writing §

### Public Relations

### Religious Studies §

Screenwriting and Film Studies

### Sociology §

### Teaching of Art\*

### Teaching of English\*

### Teaching of History\*

Teaching of Modern Language\*

### Teaching of Music\*:

Instrumental  
Vocal/Choral

Teaching of Speech and Theatre\*:

Communication  
Theatre

### Theatre

### Theatre and Dance:

Acting\*\*  
Dance  
Design, Technology and Stage Management

### Visual Art and Culture:

Art History and Visual Culture  
Museum Studies  
Studio Art

## COLLEGE OF BUSINESS

### Accounting §

### Construction Management

### Data Analytics

Digital Fashion and Merchandising:

Fashion Design  
Merchandising

### Economics §

### Entertainment Management

### Entrepreneurship

### Finance:

Corporate and Investments §  
Financial Planning  
Fintech

### General Business §

### Human Resource Management

### Information Technology:

Application Development §  
Cybersecurity §  
IT Infrastructure §

### Interior Design

### International Business

### Management and Leadership

### Marketing:

Advertising and Promotion §  
Marketing Management §  
Marketing Research §  
Professional Sales §

Mechanical Engineering Technology

### Risk Management and Insurance:

Enterprise Risk Management  
Insurance

Supply Chain, Logistics and Operations Management §

## COLLEGE OF EDUCATION

### Business Education

### Career and Technical Education:

Business Education  
Family and Consumer Sciences

### Child and Family Development: §

Child Development §  
Child Life  
Family Studies  
Youth Development §

### Early Childhood Education

### Elementary Education

Family and Consumer Sciences\*

### Middle School Education:

Language Arts  
Mathematics  
Science  
Social Sciences

Special Education/  
Cross Categorical

## MCQUEARY COLLEGE OF HEALTH AND HUMAN SERVICES

### Biomedical Sciences:

Anatomy and Physiology  
Cell and Molecular Biology  
Human Health Sciences

Clinical Laboratory Sciences-  
Medical Technology\*\*

### Communication Sciences and Disorders:

Audiology  
Speech-Language Pathology

### Esports Studies

### Exercise Science:

Health Studies  
Pre-Professional

### Health Services:

Clinical Services §  
Health Services §

Nursing (Completion Program for Registered Nurses) §

Nursing (Pre-Licensure, Four-Year Program) \*\*

### Nutrition and Dietetics

### Physical Education\*

### Psychology §

Radiography:\*\*  
Education

Management  
Science

### Respiratory Therapy:\*\*

Education  
Management  
Science

### Social Work\*\* §

### Sport and Recreation Administration

Sports Medicine

## COLLEGE OF NATURAL AND APPLIED SCIENCES

### Biology\*:

Environmental Biology and Evolution  
Microbiology and Biotechnology  
Wildlife Biology

### Chemistry\*:

Biochemistry  
Chemistry

Chemistry Education Pathway

### Civil Engineering\*

Community and Regional Planning

### Computer Science:

Computer Science  
Software Development

### Data Science

Earth Science Education Pathway

### Electrical Engineering\*

Geography and Sustainability\*

### Geology

### Geospatial Sciences

### Mathematics\*:

Actuarial Mathematics  
Applied Mathematics  
General Mathematics  
Statistics

### Mathematics Education\*

### Mechanical Engineering\*

### Physics:

Astronomy and Astrophysics  
Career Prep Physics  
Materials Science  
Teaching Prep Physics

### Physics Education Pathway

Wildlife Conservation and Management

## INTERDISCIPLINARY PROGRAMS

### General Studies

### Individualized Major

## PRE-PROFESSIONAL PROGRAMS

These paths prepare you to enter a graduate degree program that will lead to a career in health, law or engineering. Many MSU majors will provide you a foundation for these programs. MSU students are regularly admitted to leading schools in all professional areas.

### Pre-Athletic Training

### Pre-Chiropractic

### Pre-Dentistry

### Pre-Engineering

### Pre-Law

### Pre-Medicine

Pre-Occupational Therapy

### Pre-Optometry

### Pre-Pharmacy

### Pre-Physical Therapy

### Pre-Physician Assistant Studies

Pre-Veterinary Medicine

\* Offered as a free-standing major (e.g., mathematics) or as a major with a specialization (e.g., mathematics with an option in statistics).

\*\* Offered in cooperation with professional schools. Admission to Missouri State does not guarantee admission to the professional school. Explore undergraduate catalog for details.

† These programs are housed in the department of the subject area.

†† A competitive admission program. Explore undergraduate catalog for program requirements.

§ Degrees that may be completed 100% online. For a full list of all majors, minors, certificates and graduate programs that are 100% online, explore: [MissouriState.edu/Online](https://MissouriState.edu/Online)

\* Offered in cooperation with Missouri University of Science and Technology. Contact the cooperative engineering program director at 417-837-2315 or [Engineering@MissouriState.edu](mailto:Engineering@MissouriState.edu).

## MEET THE FACULTY

9:30 a.m.–12 p.m., Foster Recreation Center courts

**Darr College of Agriculture**

**Reynolds College of Arts, Social Sciences  
and Humanities**

**College of Business**

**College of Education**

**McQueary College of Health and  
Human Services**

**College of Natural and Applied Sciences**

**Honors College**

**MSU Libraries**

**170+**  
BACHELOR'S DEGREE  
OPTIONS

## STUDENT LIFE EXPO

9:30 a.m.–12 p.m., Foster Recreation Center courts

- Army ROTC
- Athletics
- Band
- Career Center
- Center for Academic Success and Transition
- Center for Community Engagement
- Computer Service Help Desk
- Education Abroad
- Financial Aid
- Foreign Language Institute
- Foster Recreation Center
- Fraternity and Sorority Life
- Hammons Hall for the Performing Arts
- Magers Health and Wellness
- Multicultural Programs
- Paws to the Polls
- Peace Corps Prep
- Plaster Student Union
- Residence Hall Association
- Residence Life, Housing and Dining Services
- Student Activities Council
- Student Employment
- Student Engagement
- Student Government Association
- Student Success
- Student Support and Opportunity Services
- Sustainability
- The Standard, Missouri State's student-run newspaper
- Traditions Council
- University Ambassadors

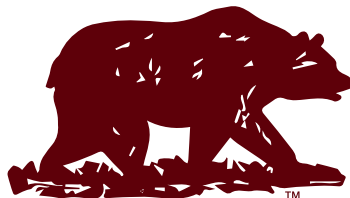

## CAMPUS MAP

- Location of key activities (see Schedule At-A-Glance)
- Academic buildings
- ★ Open buildings
- 🚌 PSU North shuttle stop
- Residence halls

